



MOD CEILING

Acoustic **Comfort**, Aesthetic **Integrity**.

acousticmod.com

ABOUT US

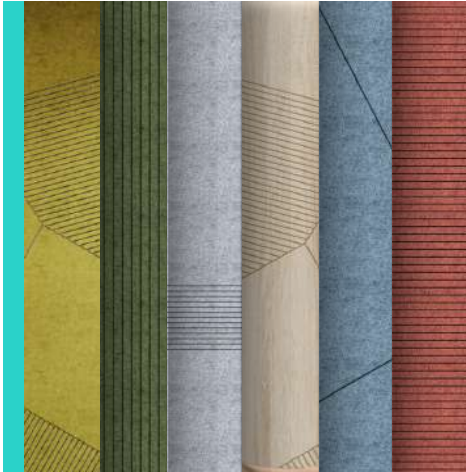

AcousticMOD

is a leading manufacturing company in PET felt production. Our goal is to provide innovative consumer and commercial textile products to markets around the world. **We design high quality acoustic absorbers to improve acoustic performance indoors, enhancing communication and concentration levels.** We are known for our commitment to achieving the best acoustic and decorative results for spaces

MANUFACTURE

We design and produce our products by dedicating ourselves to uncovering customer needs and striving to meet them. We proudly offer complimentary services focusing on our expertise in acoustics and interior design. Our team is willing to collaborate with architects, interior designers and facility planners to achieve optimal solutions in the fields of acoustics and aesthetics for indoor environments. Our mission is to provide innovative, market-oriented solutions with specialized products tailored to unique customer requirements. Representing the experience behind our organization, the AcousticMOD team is committed to the core principles of continuous diversification, continuous growth and sustainability



X
E
D
N
I

T Series

Base	1-2
Zero	3-4
Quard	5-6
Curvy	7-8
Dot Mini	9-10
Installation Method-1	11

Canopy Series

Dot Line	15-16
Dot Max	17-18
Dot Round	19-20
Plate 60	21-22
Plate 120	23-24
Plate 80	25-26
Plate XL	27-28
Installation Method-2	29

Colors

T SERIES

Seamlessly integrated into clip-in and stone wool ceilings, our panels bring acoustic comfort and visual elegance together.

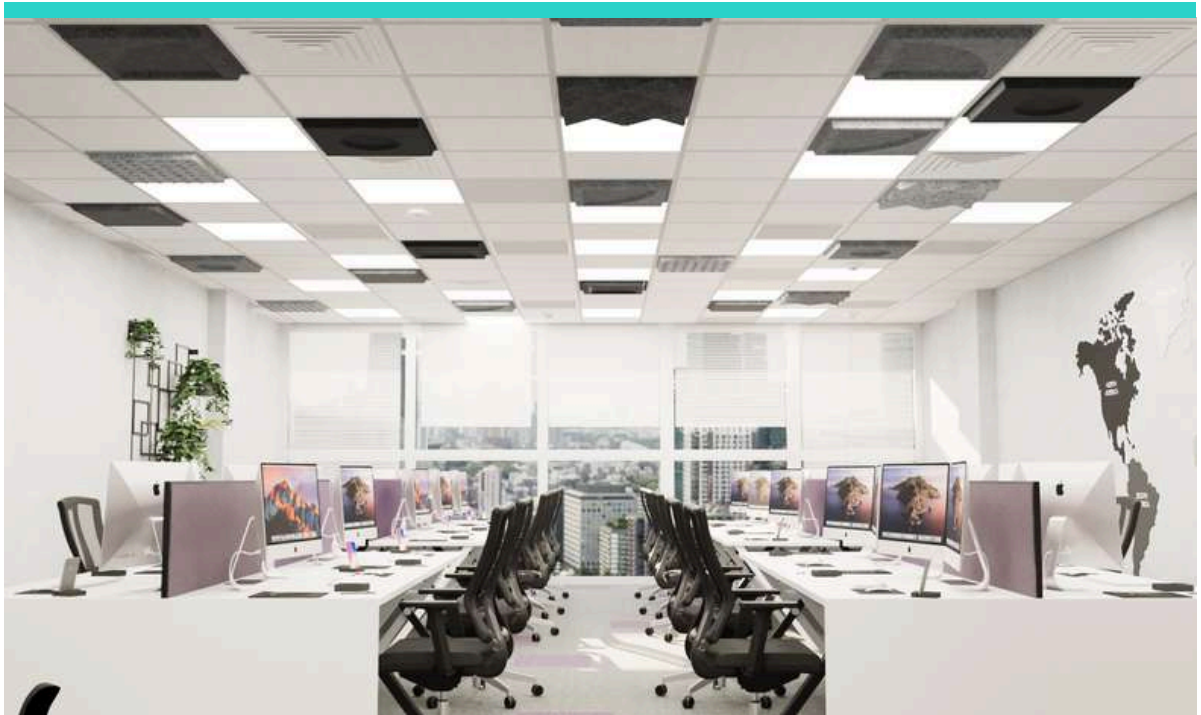

Acoustic Excellence That Adapts to Your Space

Our acoustic solutions are seamlessly compatible with clip-in and stone wool ceiling systems, combining architectural aesthetics with high performance. Thanks to their modular design, they offer fast and effortless installation while delivering superior sound insulation and echo control.

From modern offices to educational institutions, healthcare facilities to social spaces – they add value to every project with ease.

Achieve acoustic comfort without compromising on design.

SOCIAL SPACE



LOUNGE SPACE



OPEN OFFICE

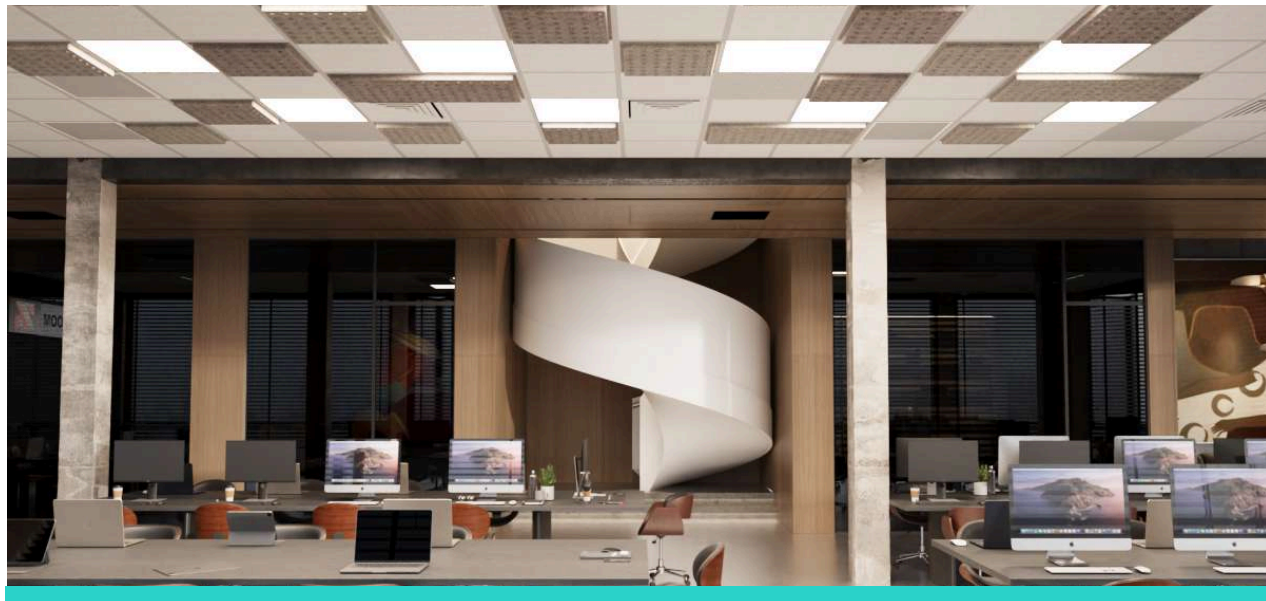

T S E R I E S

acousticMOD

BASE

CEILING PANELS

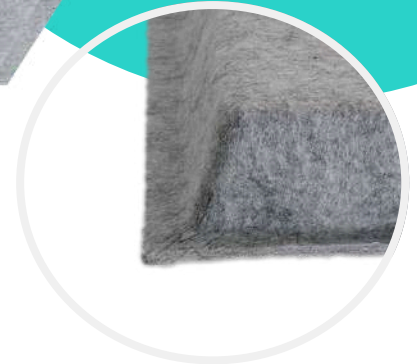
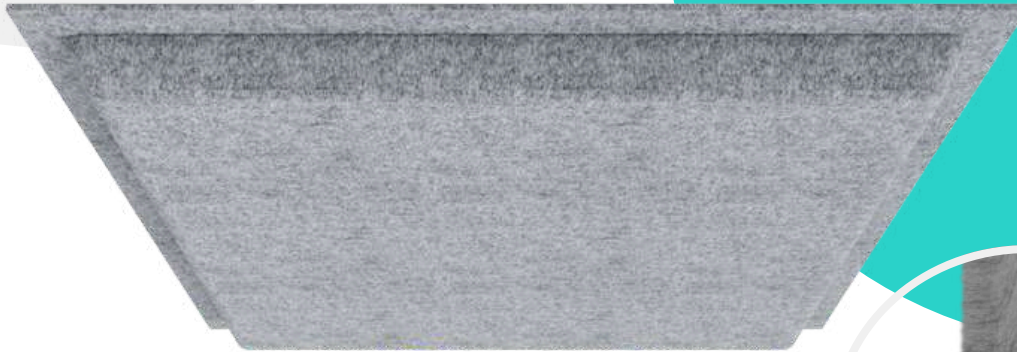

Specifications

Brand	acousticMOD
Product Name	Base
Material	100% Polyester (Recycled PET approx. 50%)
Standard Size	23.62"x23.62"x1.57" 600x600x40mm
Felt Thickness	0.15" 4mm
Material NRC	0,70
Total Product Weight	1200 gr/m ² (+/- 5%)
Field of Use	For Ceiling
Package Size	24.40"x24.40"x2.36" 620x620x60mm
Fire Reaction Class	B-s1, d0

Application Method

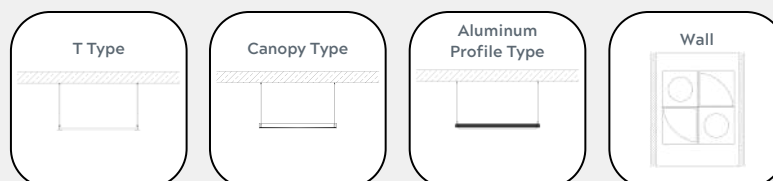

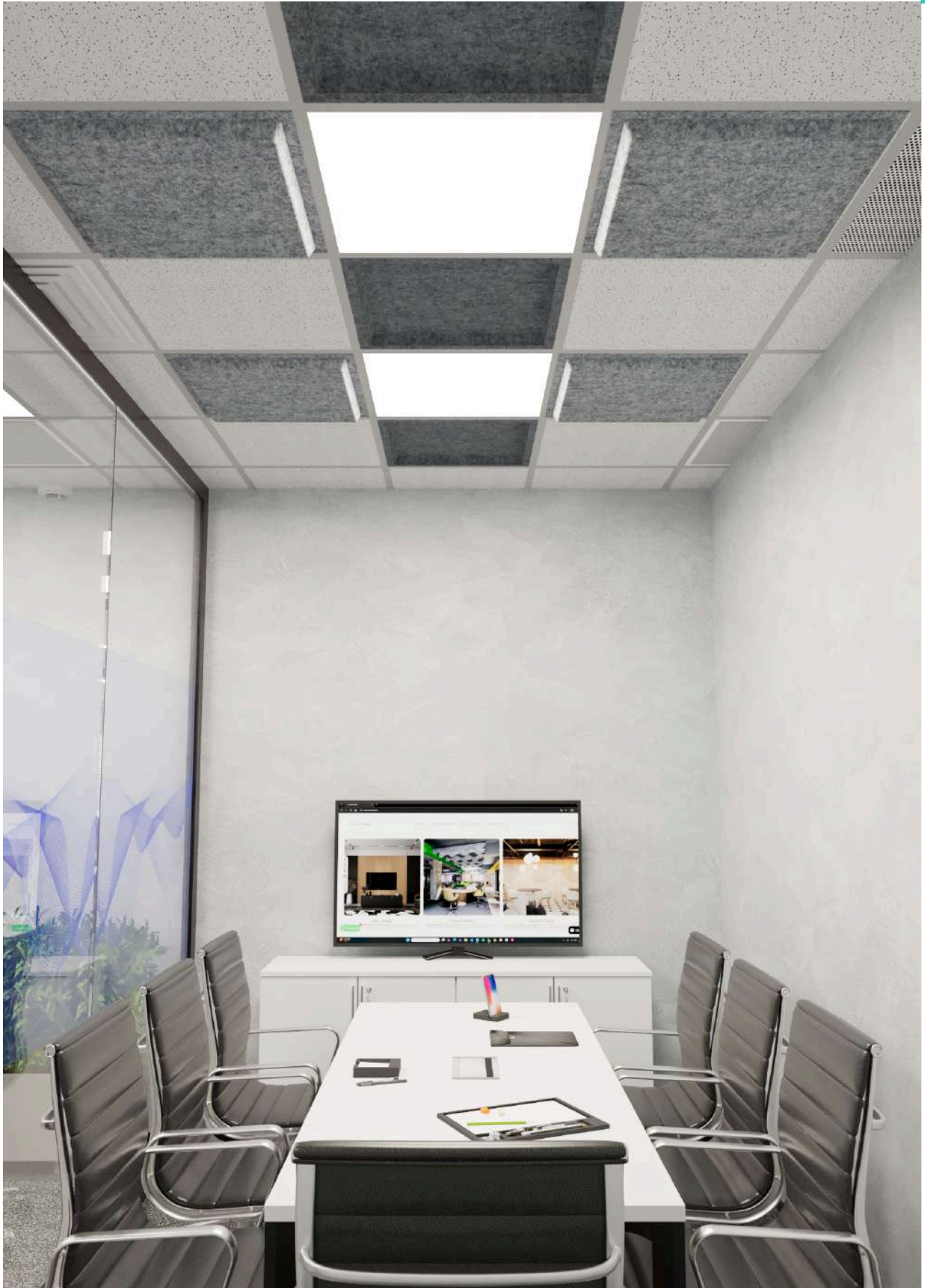

ZERO

CEILING PANELS

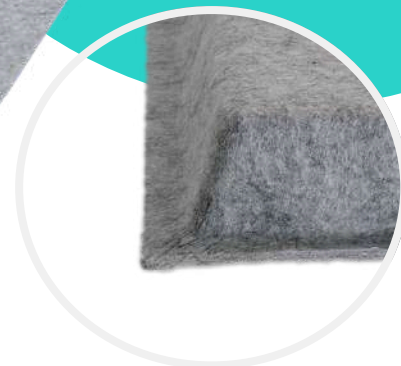
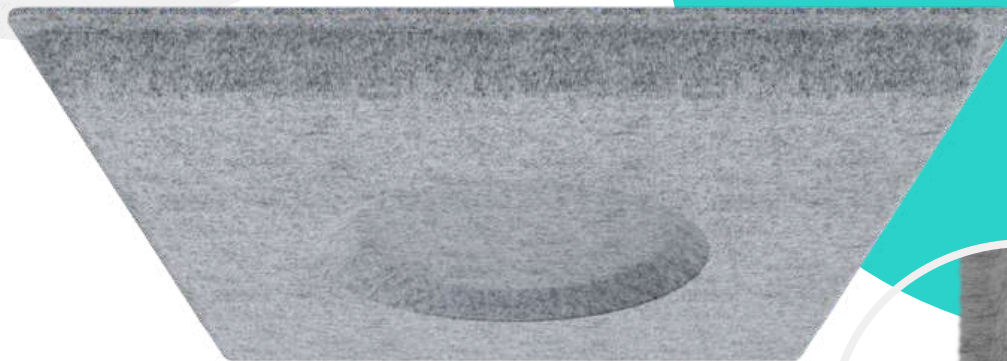

Specifications

Brand	acousticMOD
Product Name	Zero
Material	100% Polyester (Recycled PET approx. 50%)
Standard Size	23.62"x23.62"x1.57" 600x600x40mm
Felt Thickness	0.15" 4mm
Material NRC	0,70
Total Product Weight	1200 gr/m ² (+/- 5%)
Field of Use	For Ceiling
Package Size	24.40"x24.40"x2.36" 620x620x60mm
Fire Reaction Class	B-s1, d0

Application Method

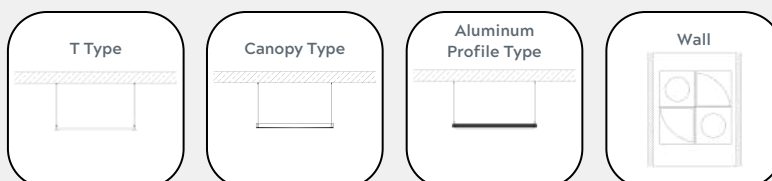



QUARD

CEILING PANELS

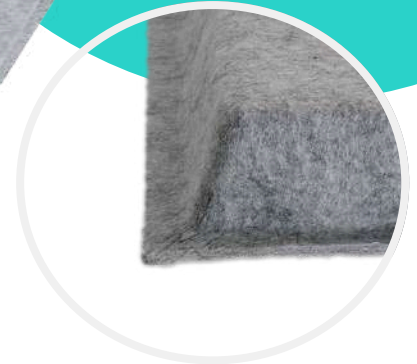
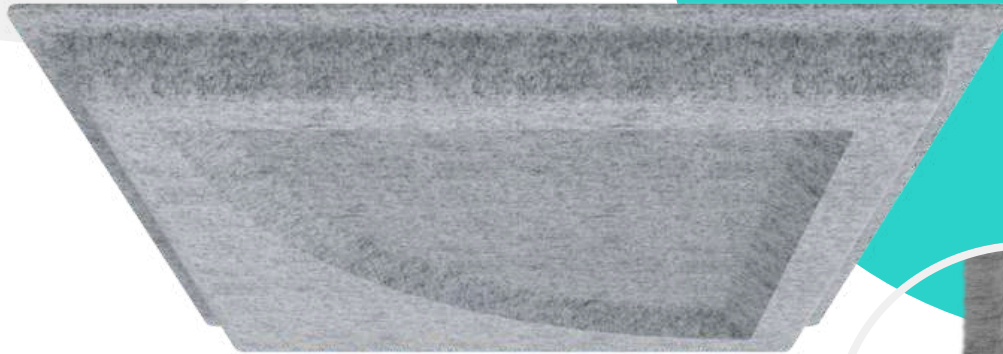

Specifications

Brand	acousticMOD
Product Name	Quard
Material	100% Polyester (Recycled PET approx. 50%)
Standard Size	23.62"x23.62"x1.57" 600x600x40mm
Felt Thickness	0.15" 4mm
Material NRC	0,70
Total Product Weight	1200 gr/m ² (+/- 5%)
Field of Use	For Ceiling
Package Size	24.40"x24.40"x2.36" 620x620x60mm
Fire Reaction Class	B-s1, d0

Application Method

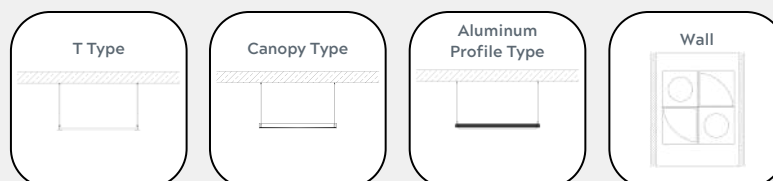



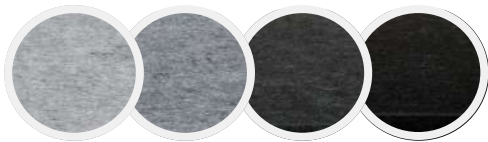
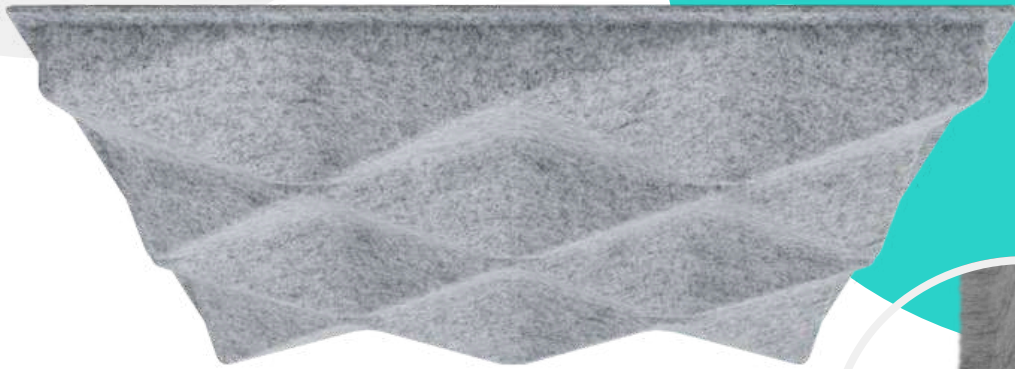

Specifications

Brand	acousticMOD
Product Name	Curvy
Material	100% Polyester (Recycled PET approx. 50%)
Standard Size	23.62"x23.62"x1.57" 600x600x40mm
Felt Thickness	0.15" 4mm
Material NRC	0,70
Total Product Weight	1200 gr/m ² (+/- 5%)
Field of Use	For Ceiling
Package Size	24.40"x24.40"x2.36" 620x620x60mm
Fire Reaction Class	B-s1, d0

Application Method

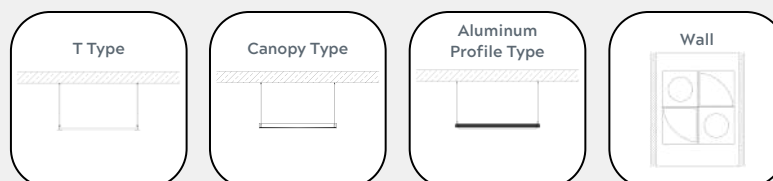

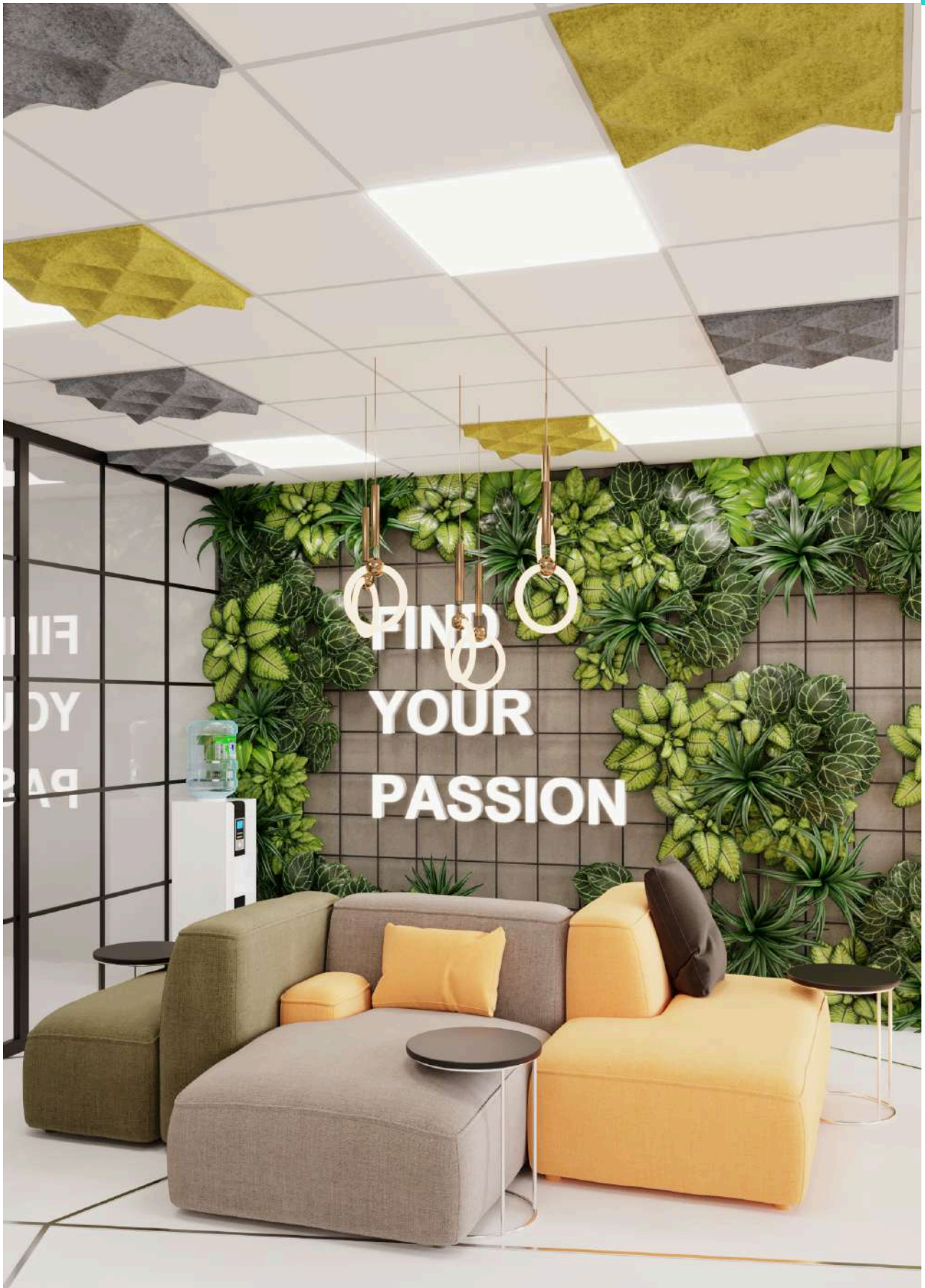

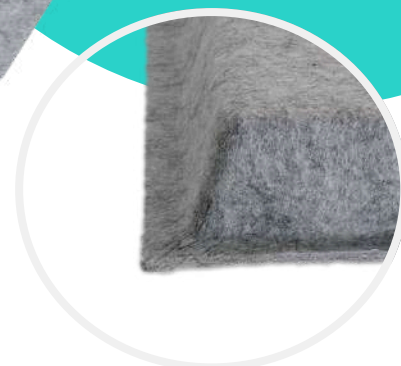
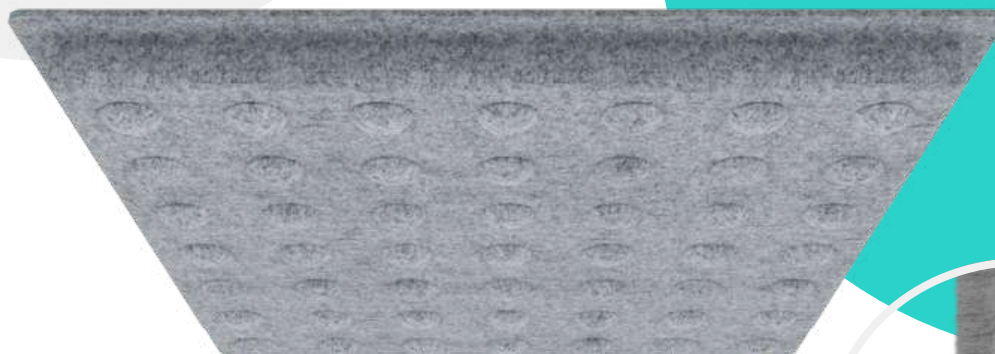

Specifications

Brand	acousticMOD
Product Name	Dot Mini
Material	100% Polyester (Recycled PET approx. 50%)
Standard Size	23.62"x23.62"x1.57" 600x600x40mm
Felt Thickness	0.15" 4mm
Material NRC	0,70
Total Product Weight	1200 gr/m ² (+/- 5%)
Field of Use	For Ceiling
Package Size	24.40"x24.40"x2.36" 620x620x60mm
Fire Reaction Class	B-s1, d0

Application Method

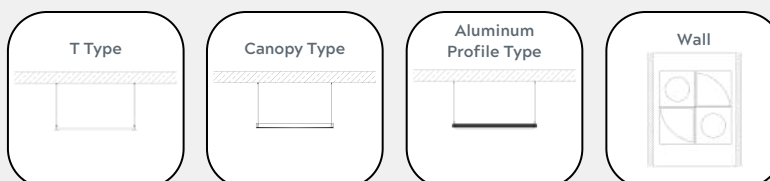



INSTALLATION METHOD - 1

AcousticMOD **Made ceiling modules are easy to install onto your ceiling.**

Quick and simple installation allows you to instantly transform any space. You can easily assemble it yourself and turn your office, meeting room, lobby area, or even your clinic into a beautiful and modern environment in no time.

STEP 1

Compatibility

Easily compatible with both clip-in and mineral wool ceiling systems.

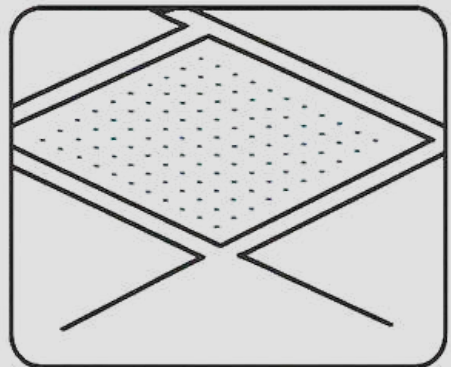

STEP 2

Remove Tile

Carefully remove one of the clip-in or mineral wool ceiling tiles from the target area.

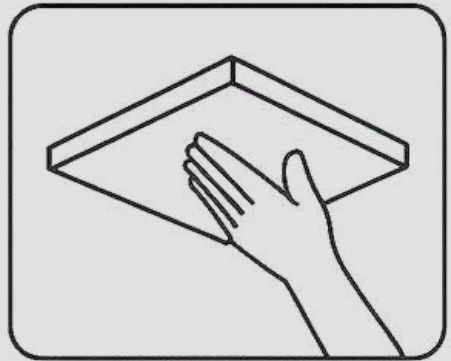

STEP 3

Insert Made

Insert the 60x60 cm MADE unit into the open space with ease and precision.

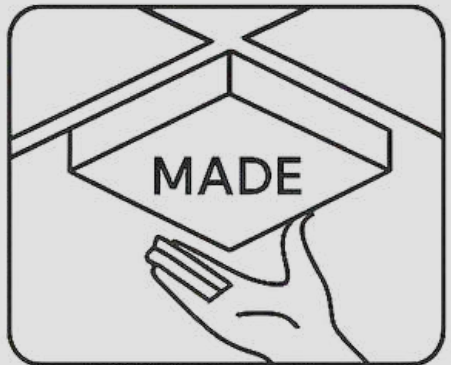

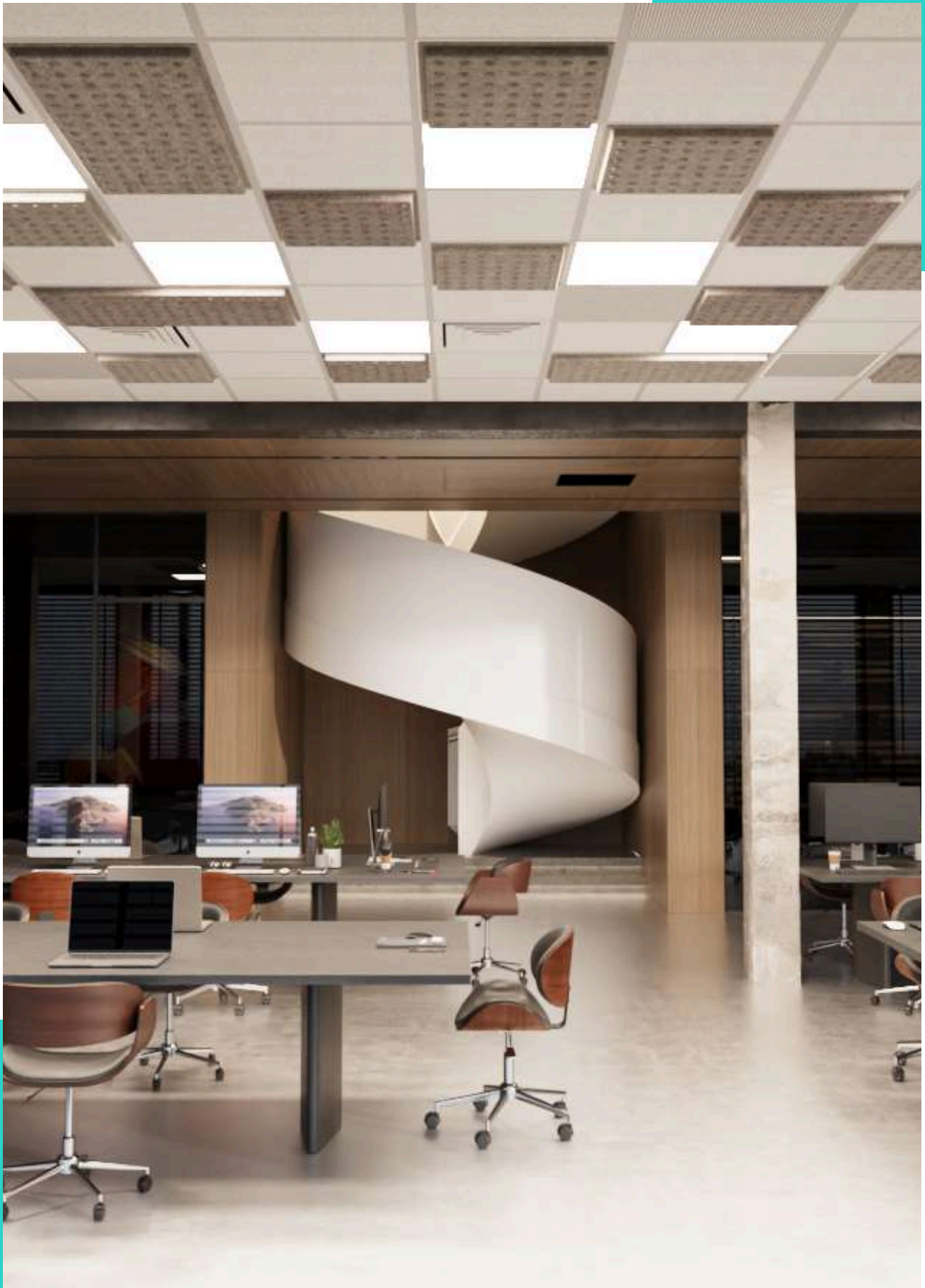

CANOPY SERIES

Our panels are seamlessly integrated into industrial and open ceiling systems, **bringing together acoustic comfort and visual elegance.**

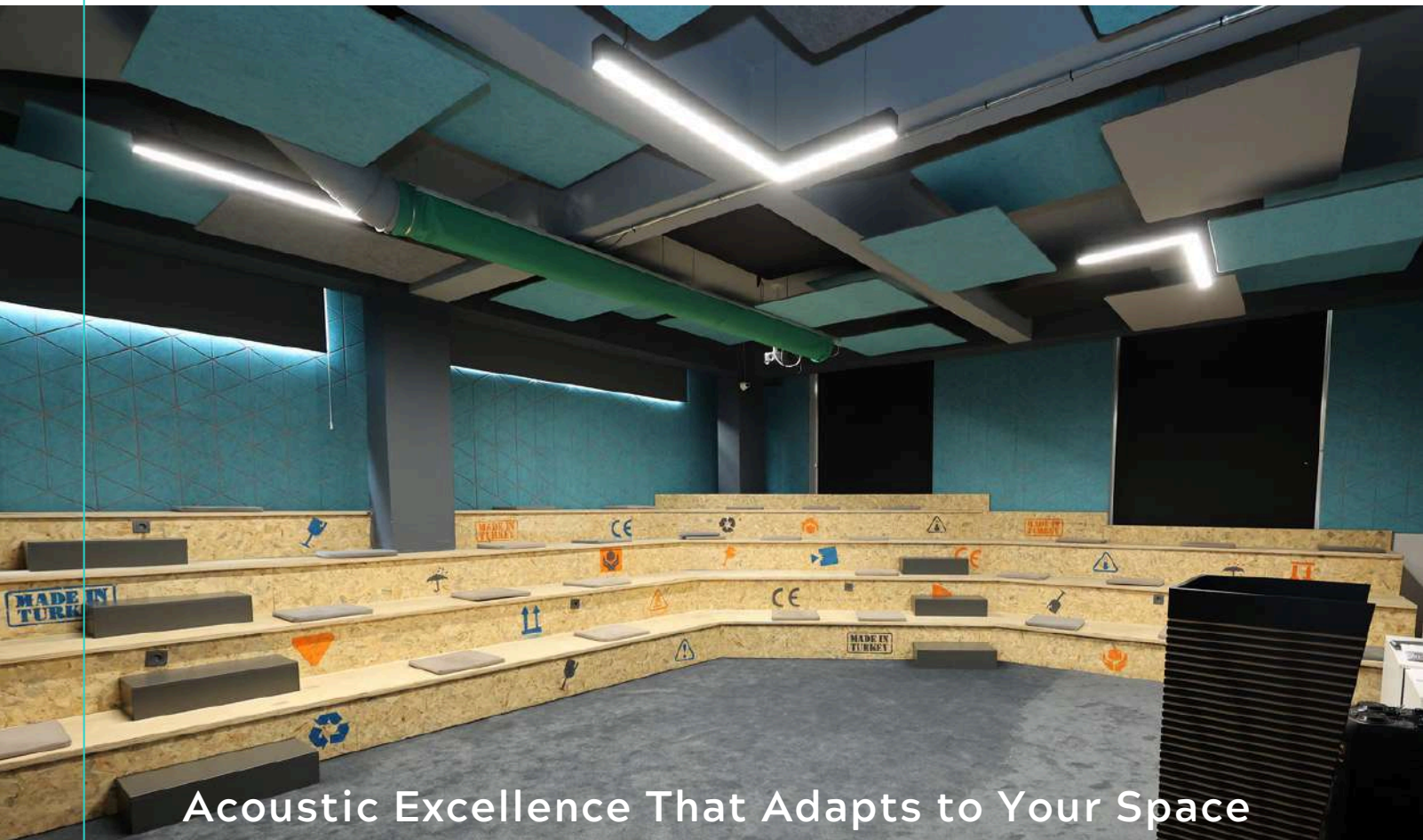

Acoustic Excellence That Adapts to Your Space

Our acoustic solutions are compatible with industrial and open ceiling systems, combining architectural aesthetics with high performance.

Thanks to their modular design, they offer excellent sound insulation and echo control while maintaining a stylish and elegant appearance.

From modern offices and educational institutions to healthcare facilities and social spaces, they effortlessly add value to any project.

Achieve acoustic comfort without compromising on design.

CANOPY

CANOPY SERIES

TRAINING ROOM

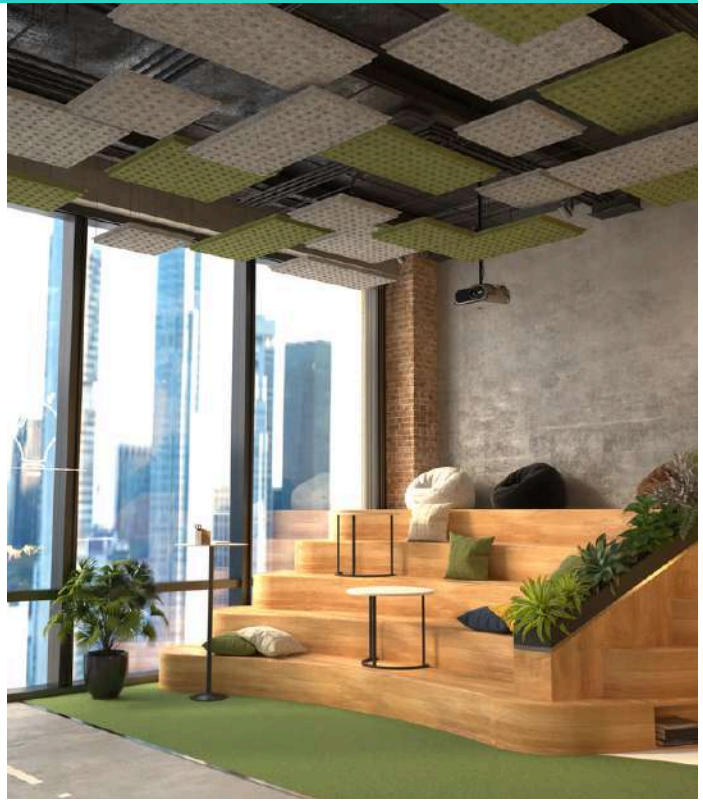

SOCIAL SPACE

CONFERENCE SPACE



DOT LINE

CEILING PANELS

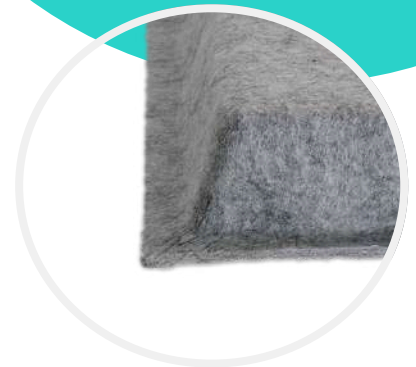
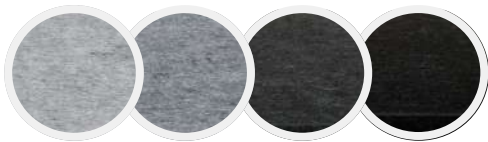
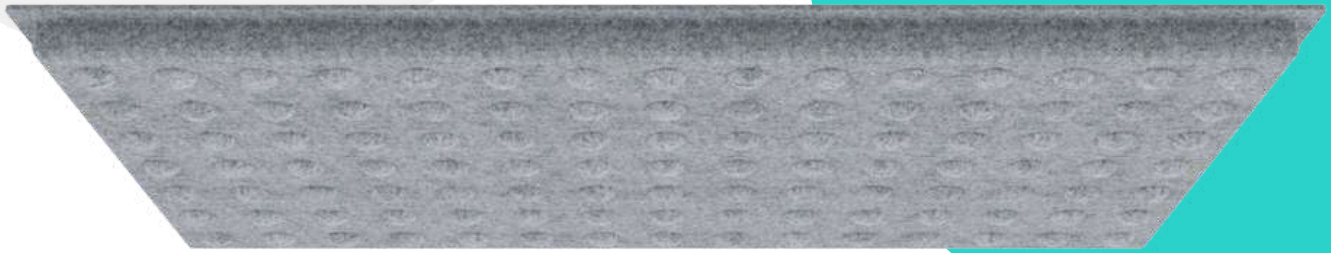

Specifications

Brand	acousticMOD
Product Name	Dot Line
Material	100% Polyester (Recycled PET approx. 50%)
Standard Size	47.24"x23.62"x1.57" 1200x600x40mm
Felt Thickness	0.15" 4mm
Material NRC	0,70
Total Product Weight	1200 gr/m ² (+/- 5%)
Field of Use	For Ceiling
Package Size	48.03"x24.40"x2.36" 1220x620x60mm
Fire Reaction Class	B-s1, d0

Application Method

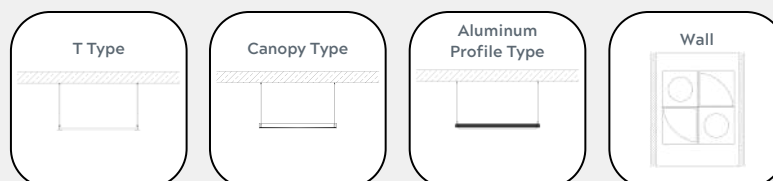

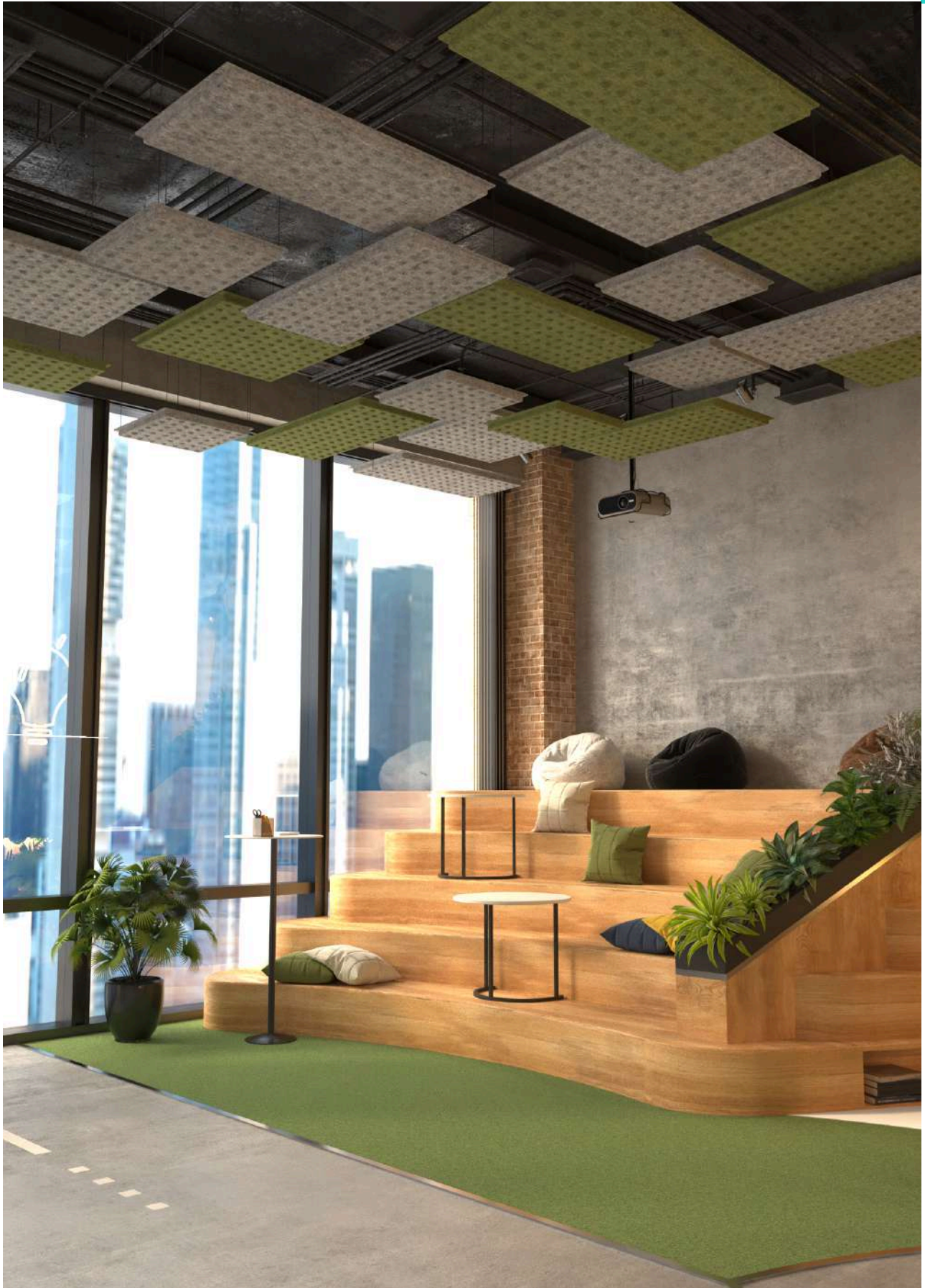

DOT MAX

CEILING PANELS

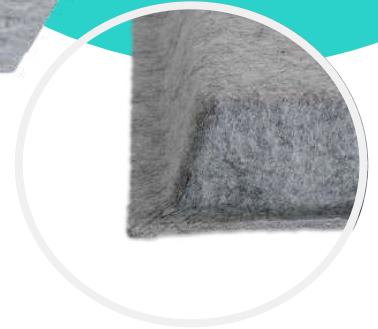
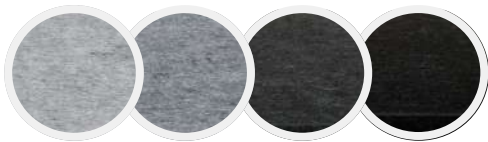
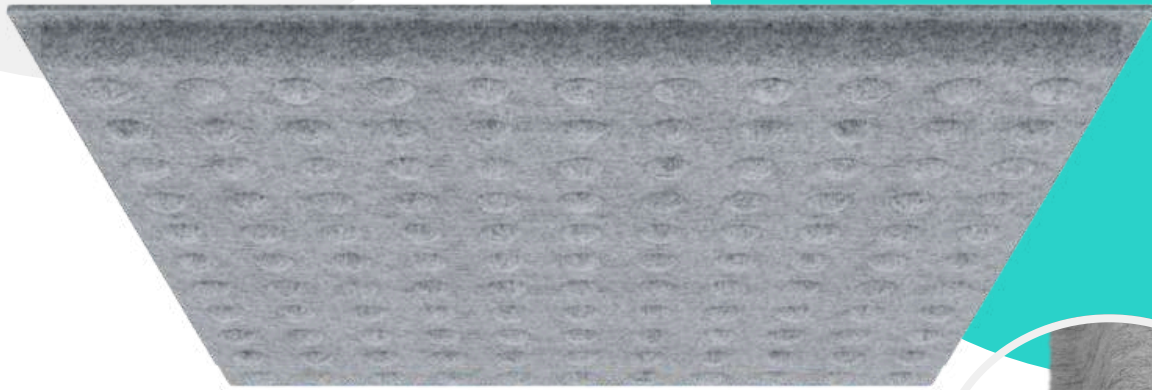

Specifications

Brand	acousticMOD
Product Name	Dot Max
Material	100% Polyester (Recycled PET approx. 50%)
Standard Size	35.43"x35.43"x1.57" 900x900x40mm
Felt Thickness	0.15" 4mm
Material NRC	0,70
Total Product Weight	1200 gr/m ² (+/- 5%)
Field of Use	For Ceiling
Package Size	36.22"x36.22"x2.36" 920x920x60mm
Fire Reaction Class	B-s1, d0

Application Method

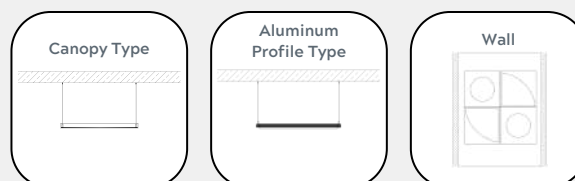

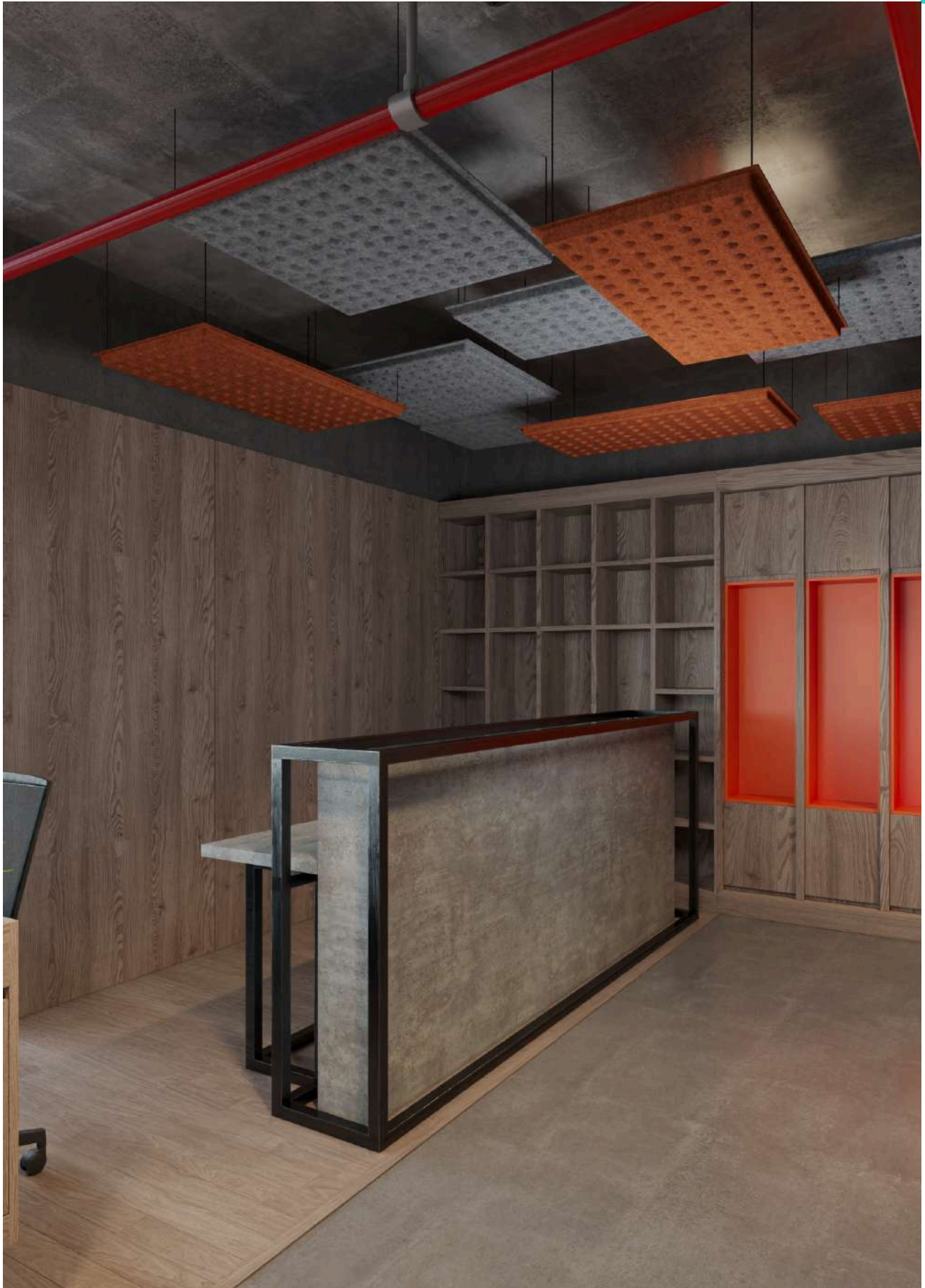

DOT
ROUND

CEILING
PANELS

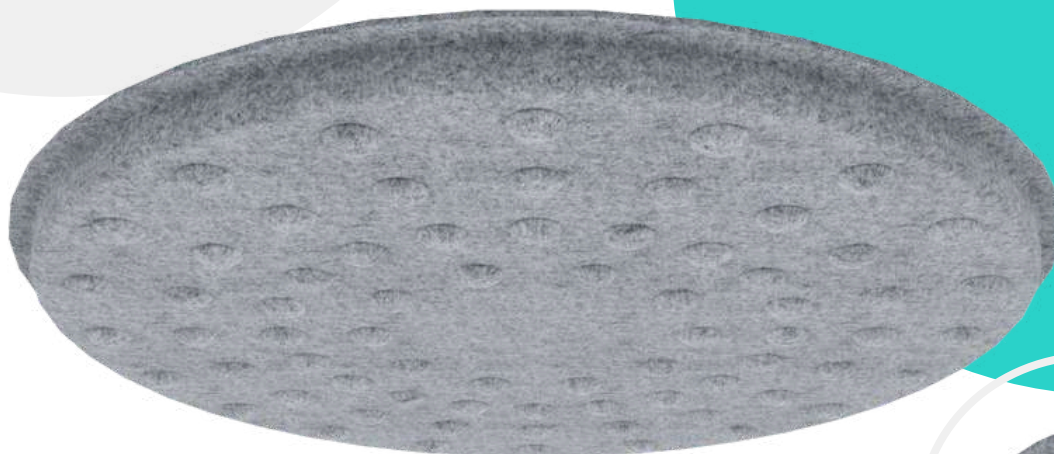

Specifications

Brand	acousticMOD
Product Name	Dot Round
Material	100% Polyester (Recycled PET approx. 50%)
Standard Size	35.43"x35.43"x1.57" 900x900x40mm
Felt Thickness	0.15" 4mm
Material NRC	0,70
Total Product Weight	1200 gr/m ² (+/- 5%)
Field of Use	For Ceiling
Package Size	36.22"x36.22"x2.36" 920x920x60mm
Fire Reaction Class	B-s1, d0

Application Method

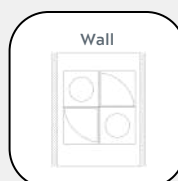
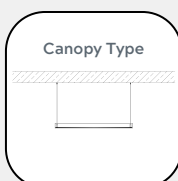





Specifications

Brand	acousticMOD
Product Name	Plate 60
Material	100% Polyester (Recycled PET approx. 50%)
Standard Size	23.62"x23.62"x1.57" 600x600x4mm
Felt Thickness	0.15" 4mm
Material NRC	0,70
Total Product Weight	1200 gr/m ² (+/- 5%)
Field of Use	For Ceiling
Package Size	24.40"x24.40"x2.36" 620x620x60mm
Fire Reaction Class	B-s1, d0

Application Method

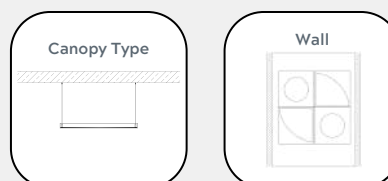



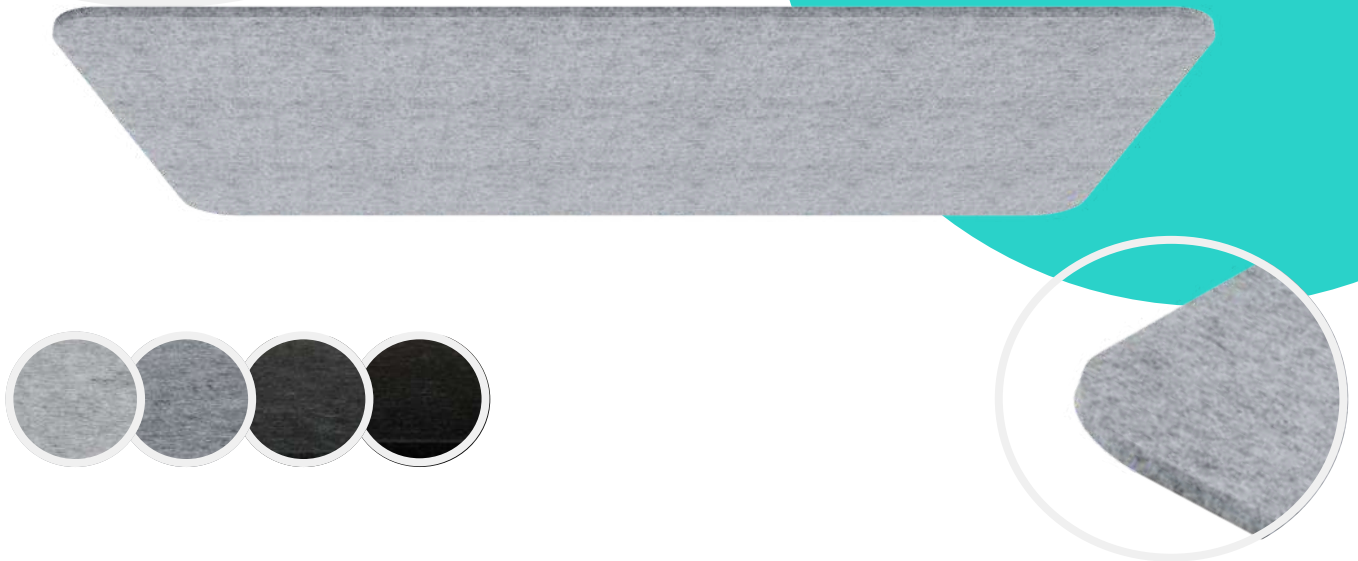

Specifications

Brand	acousticMOD
Product Name	Plate 120
Material	100% Polyester (Recycled PET approx. 50%)
Standard Size	47.24"x23.62"x1.57" 1200x600x4mm
Felt Thickness	0.15" 4mm
Material NRC	0,70
Total Product Weight	1200 gr/m ² (+/- 5%)
Field of Use	For Ceiling
Package Size	48.03"x24.40"x2.36" 1220x620x60mm
Fire Reaction Class	B-s1, d0

Application Method

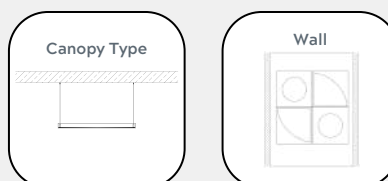





Specifications

Brand	acousticMOD
Product Name	Plate 80
Material	100% Polyester (Recycled PET approx. 50%)
Standard Size	47.24"x31.49"x1.57" 1200x800x4mm
Felt Thickness	0.15" 4mm
Material NRC	0,70
Total Product Weight	1200 gr/m ² (+/- 5%)
Field of Use	For Ceiling
Package Size	48.03"x32.28"x2.36" 1220x820x60mm
Fire Reaction Class	B-s1, d0

Application Method

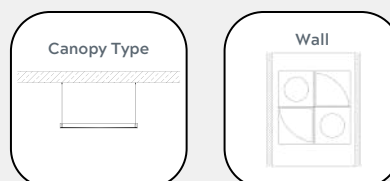

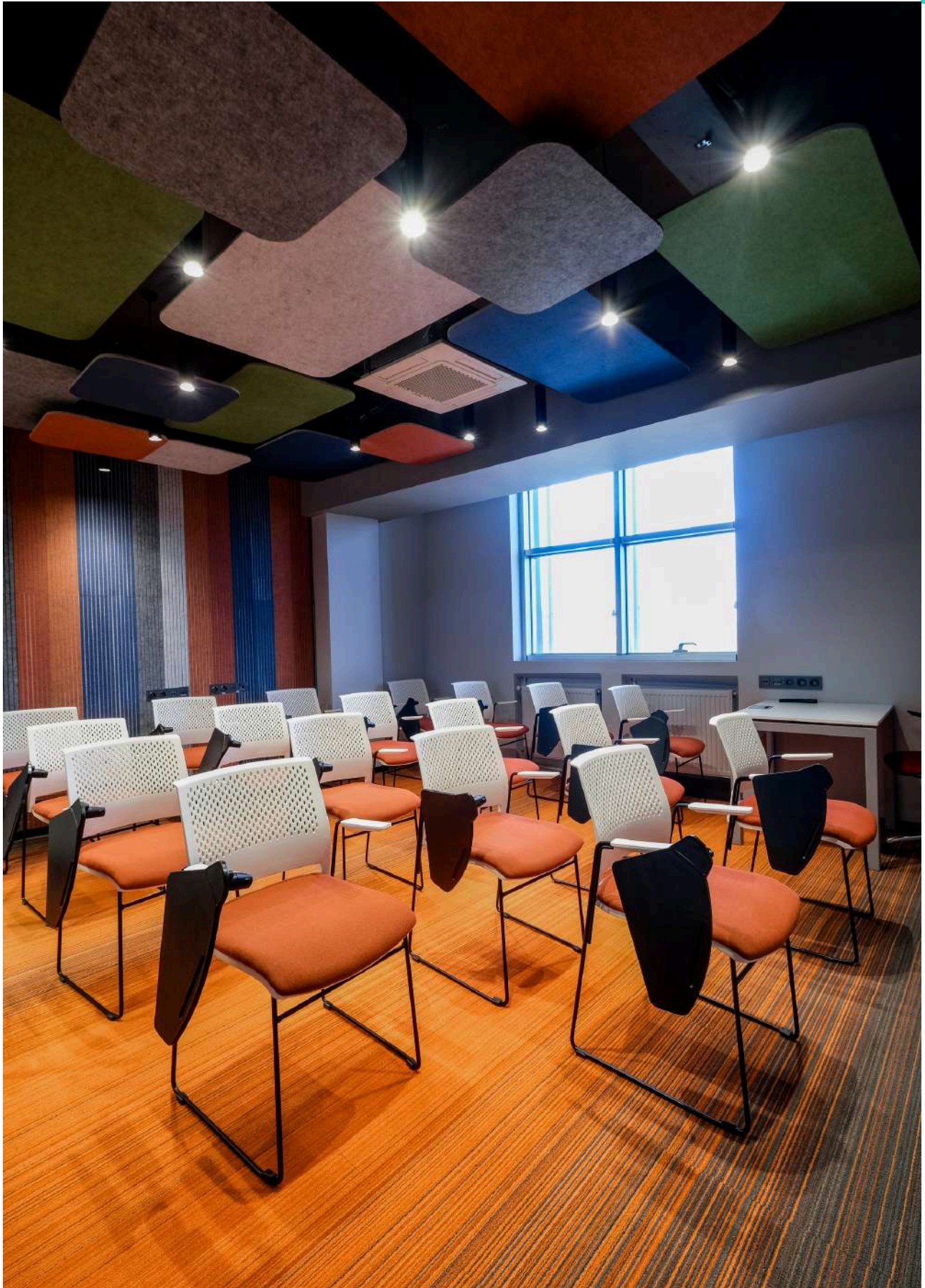



Specifications

Brand	acousticMOD
Product Name	Plate XL
Material	100% Polyester (Recycled PET approx. 50%)
Standard Size	62.99x31.49"x1.57" 1600x800x4mm
Felt Thickness	0.15" 4mm
Material NRC	0,70
Total Product Weight	1200 gr/m ² (+/- 5%)
Field of Use	For Ceiling
Package Size	63.77"x32.28"x2.36" 1220x820x60mm
Fire Reaction Class	B-s1, d0

Application Method

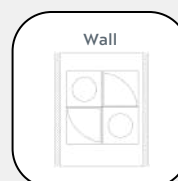
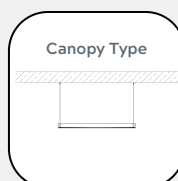

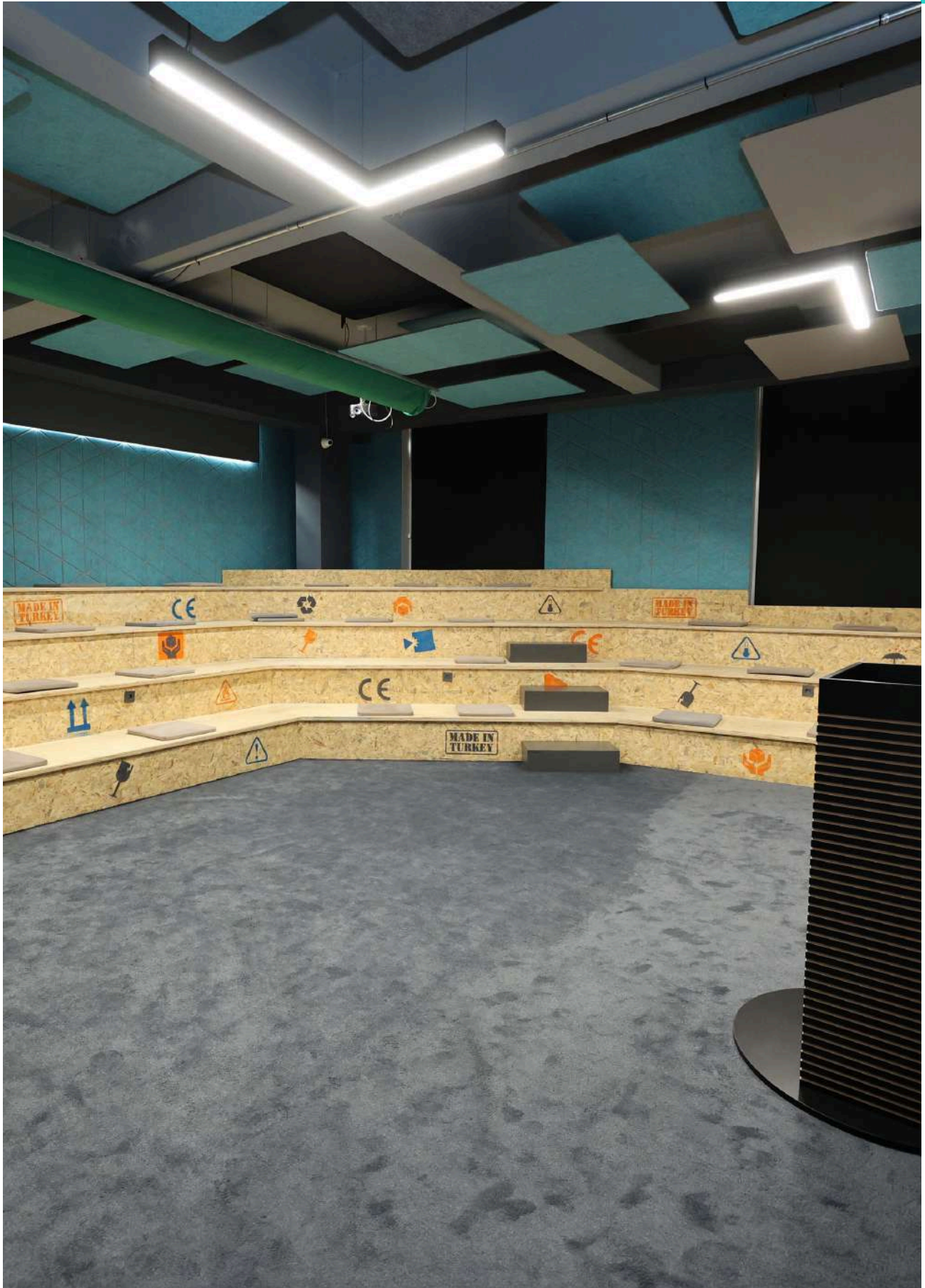

INSTALLATION METHOD - 2

AcousticMOD **Made ceiling modules are easy to install onto your ceiling.**

Quick and simple installation allows you to instantly transform any space. You can easily assemble it yourself and turn your office, meeting room, lobby area, or even your clinic into a beautiful and modern environment in no time.

STEP 1

Prepare the Materials

- Wire suspension kit
- Acoustic panel (with metal frame)
- Drill, screws, wall plugs
- Spirit level and measuring tape

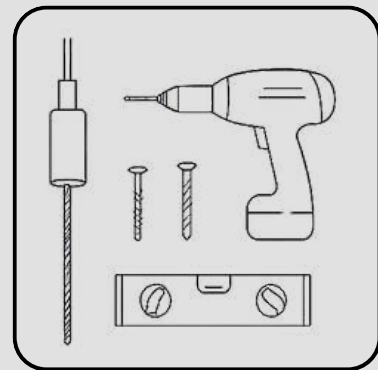

STEP 2

Mark the Suspension Points and Install the Hardware

- Fix the suspension mounts to the ceiling using wall plugs and screws.
- Insert the steel wire into the suspension mount.

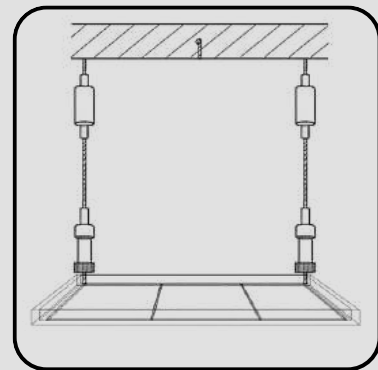

STEP 3

Hang and Level the Panel

- Attach the wire ends to the metal frame inside the panel.
- Adjust the height to ensure the panel is level and balanced.

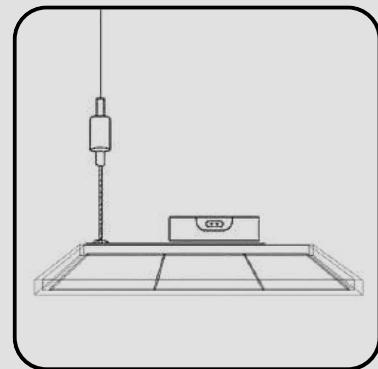





CONTACT



info@acousticmod.com



17939 Kieth Harrow Blvd 101, Houston,
TX 77084



(346) 575-3132

acousticmod.com